

LEE COUNTY SURVEY MARK DESCRIPTION

DESIGNATION 45-21-35-01 COUNTY LEE STATE FL

LOCATED IN SEC 35 TWP 45 RGE 21 USGS QUAD MAP CAPTIVA, FL.

TO REACH SURVEY MARK FROM
From the intersection of Captiva Drive and the North end of Blind Pass bridge travel North along Centerline of said Captiva Drive 2.53 Mi to a point which is on the Gulf of Mexico side of said Captiva Drive then travel into sharp curve to the right to about the center of the curve The monument is 10.0' from Wly edge of pav't. of said Captiva Drive It is 46.4' Northwest of 10" Cabbage Palm. It is 34.7' Southwest of wood "Jensen on the Gulf" sign. It is a concrete monument W/ brass disk.

TYPE OF 4X4" CONCRETE MONUMENT W/BRASS DISK

MARK LEE COUNTY PRM (LB-642) DATE REF APRIL 24, 1992

HORIZONTAL CONTROL ORIGINATED ON 2ND/1ST ORDER CONTROL BY USC & GS / NGS

ON NAD' 27 DATUM. ON NAD' 83 DATUM.

COORDINATES (FT), <u>2ND</u> ORDER	COORDINATES (FT), <u>2ND</u> ORDER
NORTHING (Y) <u>793766.178</u>	NORTHING (Y) <u>793936.029</u>
EASTING (X) <u>437069.050</u>	EASTING (X) <u>593299.497</u>

GRID: FLORIDA TRANSVERSE MERCATOR RECOVERED BY _____

ZONE WEST DATE, CONDITION _____

FIELD BOOK 2029 PAGE 71

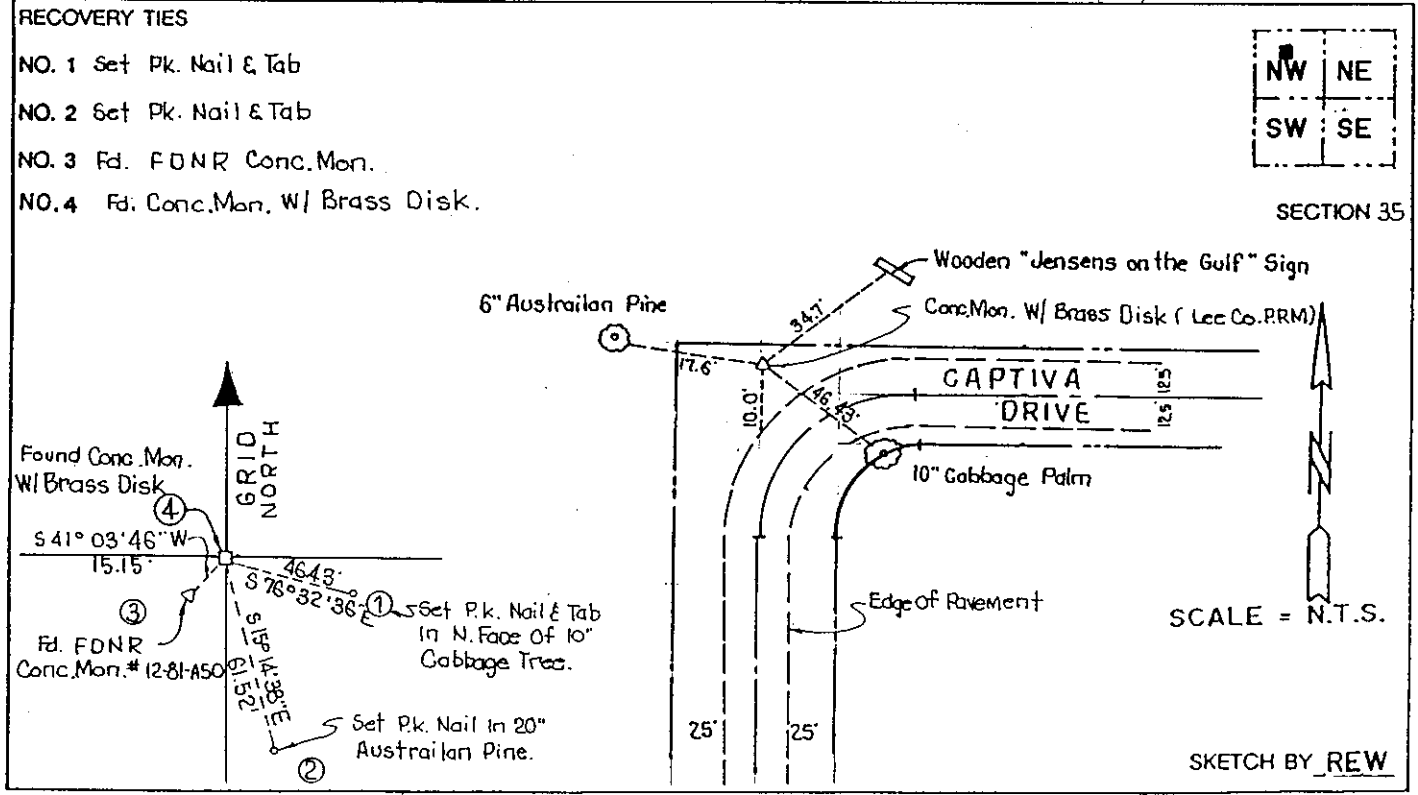

JOHNSON ENGINEERING, INC.
CIVIL ENGINEERS - LAND SURVEYORS
2158 JOHNSON STREET, POST OFFICE BOX 1550, FORT MYERS, FLORIDA, 33902-1550
PHONE (813) 334-0046

454